

SAARYN

THE NEW ZEALAND FOLK FOUNDATION PRESENTS



# THE 1995 NATIONAL FOLK FESTIVAL

ONSLOW COLLEGE, WELLINGTON  
2-5 JUNE 1995

 **NZff**  
FOLK FOUNDATION INCORPORATED

**Welcome to Onslow College**  
**and the**  
**1995 NATIONAL FOLK FESTIVAL**

organised by the committee of the New Zealand Folk Foundation

who are:

Andrew Bicknell, John Griggs

Sue Ikin, Sharyn Staley

Olivia Willard, Debbie Gillanders

If you have ANY queries please contact John, Sue or Andrew, or leave a message at the Registration Desk.

We ask that there be **NO SMOKING** inside the buildings except for the designated area in the festival cafe.

Please park your vehicles considerably - there is plenty of parking - and please leave the school **QUIETLY!**

**CLEANING**

We need volunteers to clean up afterwards - please see Ruth Birnie or leave your name at the Registration Desk.

Clean up times are: 5.30 - 7.00 pm Sunday and from 9.00 am onwards on Monday morning.

**RUBBISH**

Please look at the sign on the bag - we are recycling CANS, GLASS and PLASTIC DRINK BOTTLES

**ACKNOWLEDGEMENTS**

The New Zealand Folk Foundation acknowledges the support of:

WCC Arts and Culture Funding Committee: \$500

The Loaded Hog (Pub Charity): \$500

Original artwork: John McDonald

Artwork: Tony Larsen

Printing: Datastream Instant Print

Original artwork; registration disc: Warwick Brock

Cleaning: Ruth Birnie, Rosters: Lynda Hannah

Sound: Ian Hull Brown, Keith Riach and Paul Lloyd

### BLACKBOARD CONCERTS

For all blackboard concerts please put your name on the board and see the compere, whose name will be at the top.

### CRECHE

Creche tickets are available from the registration desk - the Creche does not handle money - only tickets and children! Creche facilities, run by Len and Barbara, from the Newtown Community Creche, will be available from:

10.30am to 12.30 and from 1.30 to 4.00pm on Saturday

10.30am to 12.30 and from 1.30 to 5.30pm on Sunday.

**COST: \$2.00 per child per hour**

### CHILDREN

School age children must be registered for the festival: \$10.00 for the full festival, including the Ballads to Blues on Saturday night or \$5.00/day for day passes only. There is no charge for children for The Friday Blues or the ceilidh on Sunday night.

### CATERING

The catering this year is being done by Ray Good of Muffins Bakery in Newlands. The usual range of snacks and light meals will be available in the cafeteria, which is in the domestic sciences classroom across the quad.

### JAMMING

The best places are in the cafe and the room next door, in the foyer by the school office, and on the main steps outside (if fine!).

### INSTRUMENTS ETC

If you want to leave your gear in a safe place ask at the Registration Desk to arrange to stow it away. No one will get unsupervised access to the storage area.

### SOUND

The sound systems at Onslow College are being provided by Keith Riach and operated by Paul Lloyd. If you have requirements for sound equipment please see Keith or Paul or a member of the committee - DO NOT help yourself.

### FESTIVAL SHOP

Ciaran Sloan from Madness Music will be running the Festival shop selling records, tapes, CDs etc. If you would like Ciaran to handle the sale of your tapes, CDs etc (for a small commission) please ask him, **not** the registration desk. The shop will be open most of the day on both Saturday and Sunday.

### PUBLICITY MATERIAL

Publicity material for concerts, festivals, CD and tapes may be put up in the foyer and corridors but please ask at the Registration Desk first.

## FESTIVAL OUTLINE

### FRIDAY NIGHT: Onslow College Social Centre, The Friday Blues

A Blues spectacular featuring Laurence Cooper, Marg Layton with Dave Murphy and Andrew Delahunty, Al Young, The Windy City Strugglers and compere John Sutherland.

### SATURDAY, 3 June, Onslow College, starting at 10.30 am.

Concerts by Cairde and Wild Geese, The Razorbacks and the first blackboard concert.

Workshops by Gordon McIntyre and Kate Delaney, Debbie Gillanders, Beverley Young, Kevin Ikin, Pat Higgins, Daniel Griggs and Frank Fyfe.

Dance workshops for Irish ceili and set dancing, Line dancing, Scottish Country Dancing.

Children's workshops and activities.

### SATURDAY NIGHT, JAMES CABARET at 8.00 pm: Ballads to Blues

Featuring Gordon McIntyre and Kate Delaney with Jimmy Young, Beverley Young, Wild Geese, Cairde, Al Young, Debbie Gillanders and compere Frank Fyfe.

### SUNDAY, Onslow College, starting at 10.30 am.

Concerts by Gordon McIntyre and Kate Delaney with Jimmy Young, Al Young, Debbie Gillanders, Beverley Young, the Absolutely, Positively Wellington concert and the second blackboard concert.

Workshops by Cairde, Al Young, Evey McAuliffe, Bob Bickerton with Jimmy Young. Dance workshops include Flamenco, Morris and Irish set dancing.

Children's activities and workshops.

### THE FINAL FLING

In the main hall starting at 8.00 pm; the ceilidh will be run by BATTERED HATS of Palmerston North. They're bound to produce some different and interesting dances to try.

### THE FINAL SING

This concert has established itself as a traditional part of the festival. This year the compere will be KEITH RIACH; well known Wellington musician, Access Radio broadcaster and Morris man. Social centre at 8.00 pm for the Final Sing.

### MIDNIGHT TO ? PARTY

Another tradition! At some time around midnight the band will stop playing, the concert will have finished and everyone can get down to some serious partying and jamming.

MONDAY: College cleanup and last get-together at THE LOADED HOG.

## THE FRIDAY BLUES PERFORMERS

### LAURENCE COOPER:

Now a solo performer based in the Hutt, Laurence has performed in various groups such as Gutbucket, Tapestry and Sneakers Fall Apart.

### MARG LAYTON, DAVE MURPHY & ANDREW DELAHUNTY:

Marg and her long-time musical partner, Dave Murphy were a highlight of the recent Canterbury Folk Festival, and they're being accompanied in The Friday Blues, by another great friend; Andrew Delahunty.

### AL YOUNG:

Traditional blues performer from Auckland. Al will be delivering a brief taste of what we might expect to hear from him in the Ballads to Blues and in his concert on Sunday afternoon.

### WINDY CITY STRUGGLERS:

The Windy City Strugglers, who originated in 1968 as a country jug blues band, and now play everything from early blues, to Cajun, to gospel, to R & B and the occasional original, are the 1994 RIANZ Folk Music section award winners.

*The Friday  
Blues*

**8PM  
FRIDAY  
2 JUNE**

**ONSLOW COLLEGE,  
WELLINGTON**

**Laurence Cooper  
Marg Layton, Dave Murphy  
& Andrew Delahunty  
Al Young  
The Windy City Strugglers**

## GORDON McINTYRE & KATE DELANEY

with JIMMY YOUNG

Gordon and Kate have been familiar faces round the Australian folk scene for many years. Gordon is renowned for his fine guitar playing and vocals, while Kate is known for her superb vocals, harmony arrangements and tin whistle playing. She also turns her hand to the concertina and the fiddle.

Over the years Gordon and Kate have maintained consistent performance standards, show great regard for the music they interpret and have demonstrated remarkable empathy with audiences they have entertained.

Gordon and Kate have worked extensively on records, radio and television; in schools, concerts, and folk clubs and have toured with the Australian Arts Council, Musica Viva and the Folk Touring Circuit. Gordon and Kate have toured New Zealand twice in recent years and have also performed in clubs and at festivals in the U.K.

Gordon and Kate's previous recordings, "Blackwaterside" and "Pleasures to Find", received excellent reviews on release and both were voted Folk Album of their respective year by the A.B.C's Sunday Folk presenter. Their new CD, "Caledonia Dreaming" was recorded at A.B.C. Studios in Adelaide and released at the National Folk Festival in Canberra.

There is a strong Scottish/Australian theme to the CD with a mixture of both traditional and contemporary material and it has received rave reviews. Other musicians featured on the album are Jimmy Young, John Munro, Kirsty McCallum and Brent Miller.

In recent months Gordon and Kate have been playing as a trio with Northumbrian piper and flute player Jimmy Young. Jimmy is well known in New Zealand, Australia and the U.K., through his involvement with Christchurch-based group Rua, and his piping is a highlight of "Caledonia Dreaming".

The trio of Gordon, Kate and Jimmy has played at the Maleny Folk Festival, the Tamar Valley Festival, the Jamberoo Folk Festival and the Geelong Celtic Festival. They also performed at the Sydney International Folk Festival, playing in concert with Andy Irvine, Rory MacLeod, Martin Carthy and Dave Swarbrick.

Gordon, Kate and Jimmy are doing a spot in the Ballads to Blues concert on Saturday night and a concert on Sunday afternoon. Jimmy is also co-hosting a workshop for pipers on Sunday morning, with uilleann piper, Bob Bickerton.





## CAIRDE

Cairde is a Gaelic word that means friends. Cairde are (left to right)  
Shena Bird  
Evey McAuliffe  
Sarah Gray  
Katie Hindle  
Anna Heinz



Over the past five years this group of five women from New Zealand, South Africa, Ireland and England has established a reputation as a fresh and dynamic performance group, bringing new meaning to the concept of acoustic music. Their repertoire includes traditional songs in Gaelic, beautiful old Irish and Scottish melodies, Church music and women's work songs, as well as music of the New Zealand pioneers.

They are in great demand around their home town, Nelson, and recent performance highlights have included the 1995 Canterbury Folk Festival, the Nelson School of Music Centennial Festival in 1994 and the 1995 Taranaki Arts Festival. They have recently released their first album; "The Call and the Answer".

Although essentially a vocal group, Cairde uses instrumental accompaniment to great effect with guitar, fiddle, flutes, tin whistles, Appalachian dulcimer, mandolin and percussion, including bodhran.

What makes Cairde unique is not only its choice of material arranged in beautiful harmonies, but also the group's ability to readily communicate the spirit of the music itself.

Cairde will be in concert in the main hall on Saturday morning at 10.30 am and can also be seen in the Ballads to Blues at night. On Sunday, the group is presenting a harmony workshop at 11.00 am and Evey is prepared to teach a song or two in Irish at 2.30 pm. Both workshops will be in the Social Centre.



## WILD GEESE

It's unusual to find in a provincial New Zealand town like Masterton, five musicians with similar heritage and musical aspirations. However, the five members of Wild Geese prove that this is possible. While they come from a wide range of musical backgrounds, their common bond is their Celtic roots, their love of folk music and their collective fondness for the odd pint of Guinness.

While their hearts are Celtic, what they play is more catholic in approach. Their songs and tunes, both traditional and contemporary, come mainly from the folk traditions of Ireland, Scotland and England. Into this mix they bring, mainly from the pen of Brendan Connor, their own original work.

Wild Geese have recorded two albums: "The Leaving" and "Occasionally Celtic", and are at present in the process of recording their third.

Wild Geese are:

Brendan Connor  
lead vocals, guitar

Mike Dew  
guitar, bouzouki  
whistle, backing vocals

Paul Turner  
Scottish small pipes  
Highland Bagpipes  
Whistle, harmonica,  
bodhran, backing vocals

Rick Laing  
bass guitar, backing vocals

Frank Bain  
drums

Wild Geese have a concert in the main hall for an hour on Saturday at midday and will also appear in the Ballads to Blues on Saturday night.



## BEVERLEY YOUNG

Beverley Young is recognised as one of New Zealand's finest singers of traditional folk song; to most people she is *the* best.

She started singing in the early 1960s, with the encouragement of her English-born father and became "hooked" on the British folk tradition, after visiting the Devonport Folk Music Club in 1967 and hearing the many and varied styles that were around then. She started as a solo performer, then added another string to her bow by joining forces with two other Devonport F M C members, Pat and Colin Bowley to sing British material in three part unaccompanied harmony. The group performed at folk festivals all over the country and stayed together until Colin's death in 1984.

Since then Beverley and Pat have continued singing together, with Pat and Colin's daughter, Clare, taking the third part. As Florabunda, they were seen on Television New Zealand's "Work of Art" series in a documentary called "Strictly A Cappella".

Beverley continued her solo singing along with her group singing and has made a number of successful festival appearances in this role. As a soloist or group singer she has guested at every major festival in New Zealand and her most recent appearance was at this year's Canterbury Festival, at Easter.

In 1985/6 she recorded her first album "Bushes and Briars"; a mixture of traditional and modern songs. The album was judged Folk Album of the year in the 1987 Record Industry Association of New Zealand Awards. Beverley's latest recording, "It's Then I Wish", was issued in late 1993 and was a finalist in the folk category of the RIANZ awards.

Beverley has lately been turning her attention more towards Irish traditional singing, although she retains her love of, and expertise with, the old British ballads.

As her recording and stage appearances show, Beverley is equally talented whether performing on her own or in harmony groups. As a soloist, she sings unaccompanied, or with the backing of Alan Young on guitar and latterly, Paul Yelder on mandola, uilleann pipes or whistle. The trio of Beverley, Alan and Paul has appeared at a number of New Zealand festivals and is featured on "It's Then I Wish"

Beverley will present a workshop on traditional ballads in the Social Centre at midday on Saturday and the trio will feature in the Ballads to Blues on Saturday night. Beverley's main concert will be in the hall at 4.30pm on Sunday afternoon.



# FRIDAY NIGHT BLUES 8pm

LAURENCE COOPER - MARG LAYTON, DAVE MURPHY, and ANDREW DELAHUNTY

AL YOUNG - WINDY CITY STRUGGLERS

## SATURDAY PROGRAMME

	HALL	SOCIAL CENTRE	CLASSROOMS	GYM
10.00	Registration desk open			
10.30	CONCERT	MEET THE GUESTS	Children's activities Brent Harpur	Irish Ceili Eileen Dorricott
11.00		Gordon McIntyre & Kate Delaney		
11.30	CAIRDE			
12.00	CONCERT	WORKSHOP Bewitched & Beguiled Bev Young	WORKSHOP Debbie Gillanders Performers' Critique	Line Dancing Moggie Grayson & Emily Clemmett
12.30				
1.00	WILD GEESE			
1.30	BLUEGRASS (The Razorbacks)	Counting the Beat Rhythm in Celtic Music Kevin Ikin	Beginners blues	Childrens activities Dave Hollis
2.00			guitar Daniel Griggs	
2.30	BLACKBOARD			Scottish Country Edith Campbell
3.00		STORY TIME Frank Fyfe (for big kids)		
3.30				
4.00		Whistle WORKSHOP	CONCERT FOR KIDS	Lorcan and Anne Dunne  Set Dancing
4.30			Liz Merton	
5.00				
5.30		Pat Higgins		
5.30	DINNER TIME			

JAMES CABARET: BALLADS TO BLUES

## SUNDAY PROGRAMME

	HALL	SOCIAL ROOM	CLASSROOMS	GYM
10.00	Registration desk open			
10.30	Absolutely Positively Wellington Concert  with 3 Guesses Tony Chad  Natalie Coynash & Mark Sheehan Spootiskerry		10.30-12.00	10.30-12.00
11.00		Cairde	Group therapy for pipers Bob & Jimmy	Childrens Activities Paula Mason
11.30		Harmony Workshop		Morris  Pride of Holland Street
12.00				
12.30	CONCERT Debbie Gillanders	Al Young		
1.00		Gospel	Frank Fyfe for kids	Flamenco Fae Therese
1.30				
2.00	CONCERT Gordon McIntyre & Kate Delaney with Jimmy Young			
2.30		Sing a Song in Irish Evie McAuliffe		Dancing for children Glenda Griggs
3.00				
3.30	CONCERT Al Young			Set dancing
4.00		Blackboard Concert	Childrens Activities Julie Daniell	Lorcan & Anne Dunne
4.30	CONCERT Beverley Young			
5.00				
5.30	DINNER TIME			
8.00	Final Fling Battered Hats	Final Sing Keith Riach		
PARTY : Midnight to ??????				

## AL YOUNG

Al Young has been playing and studying blues for nearly 30 years and in his words, "all it got me is nearly 30 years older". But it has also earned him a reputation that means when a compere anywhere in New Zealand introduces "Mr Blues", he or she is probably introducing blues player, singer, writer, historian and broadcaster, Al Young.

His interest in blues was sparked around 1964 by the work of the British "beat" groups like the Rolling Stones, the Animals and others who were exploring the rich field of the blues. He quickly moved on to listening to, and studying the genuine article, and is today known throughout New Zealand and Australia as a top traditional blues performer and as a leading authority on the subject. He has appeared at major festivals in both countries and has done TV work, radio programmes and lectures on blues.

In 1985 Al recorded "That's No Way To Get Along", which was that year's Folk Album of the year. Ten years on he's planning another album, which will include tracks recorded at a studio in Mississippi during a recent journey to the United States. This isn't the only playing he's done in the "home of the blues" - during trips to the South he's played at a Mississippi jook joint, over a Memphis radio station and at bars on Memphis' famous Beale Street and in Mississippi. He was also a guest on the famous and long-running "King Biscuit Blues" on KFFA in West Helena, Arkansas.

Al's music covers a wide range of blues, but his first love is the hard-driving sounds of the Mississippi Delta. "What I play is the fundamental, down-home blues, the blues before it got dressed up, went to town, and fell into bad company". As well as being a solo performer, Al has worked with a variety of "electric" blues bands, including his own Famous Al Young Blues Trio and, most recently, the Great Blues Adventure.

His latest venture is "what will be a book if I can get a publisher". It won't be on the blues but on gospel music. "Philosophically, gospel and blues are miles apart, but musically there are many links", Al says. His most recent time in the States has been spent interviewing gospel music figures, attending concerts and "going to church". He doesn't have a publisher for the project yet, but U.S. academic publishers have expressed interest, so he's living in hope.

Al will be presenting a workshop on gospel music in the Social Centre at 12.30 pm on Sunday afternoon and can also be seen singing the blues at the Ballads to Blues, and in his own concert at 3.30 pm on Sunday in the main hall. He also has a spot in the Friday Blues in the Social Centre on Friday night.

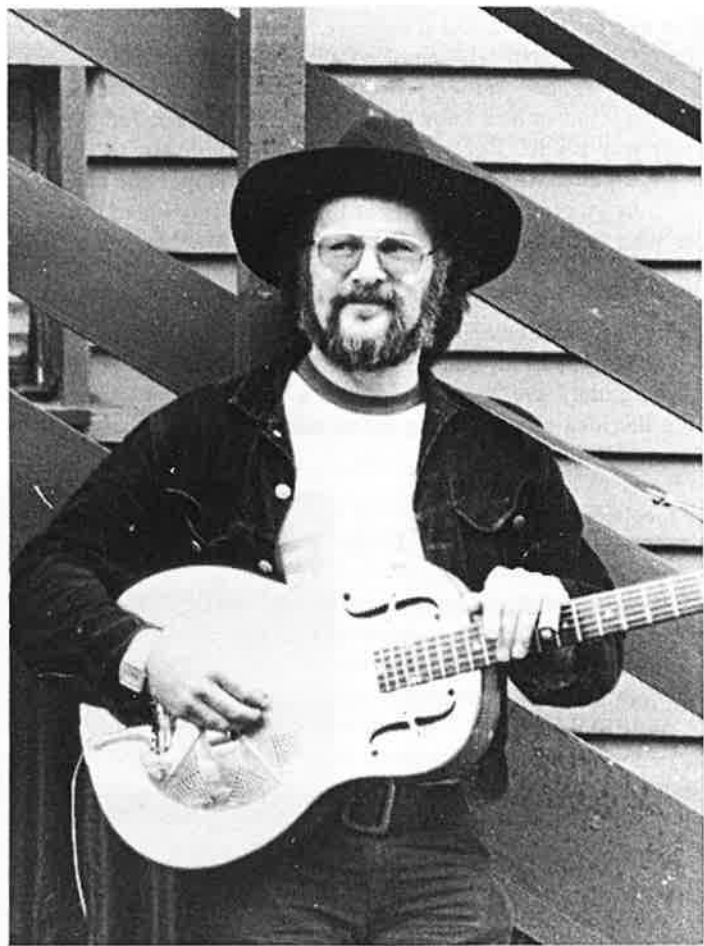



## DEBBIE GILLANDERS

With an eye for the daft and a memory like a well blocked sieve, Debbie is that rare thing - a woman who employs the art of raconteur. She has been called many things in her time - provocative, political, audacious, a shy, retiring opportunist - but is best known for her sad stories and funny songs. Or is that the other way round? Debbie's fave food is Marmite (British) and her ambition is to own a guitar with an elliptical ambient envelope. She enjoys strong coffee and defends vigorously the rights of big words everywhere to be used freely by people who actually know what they mean. She sings a bit too, and plays guitar. People seem to like it.

Recalling that, as Eccles put it, "Everybody got to be somewhere", Debbie is running a workshop for budding players and singers who are reasonably happy with where they are, but would like a bit of constructive criticism before tackling the idea of performing for an audience.

The idea is to do an item, and either specify a particular aspect for comments to focus on, eg "Are my words clear?", or have your performance discussed in general terms. Mary Hubble and Dave Nicholson will be joining Debbie for this session, which will probably be of the unplugged variety. At midday on Saturday, any offers of coffee will be accepted gratefully.

You can also see Debbie in the Ballads to Blues on Saturday night and in her own concert in the main hall on Sunday afternoon.

Debbie would like to remind you that there are 183 shopping days left until Christmas and that she has copies of her tape for sale and that there is no connection between the two.



## OTHER FESTIVAL PARTICIPANTS

### WORKSHOP ON RHYTHM IN CELTIC MUSIC (Kevin Ikin)

Kevin Ikin has been playing in dance bands for yonks ; mainly music of Celtic origin for ceili, barn dances and other types of huili.

He did his dance circuit apprenticeship with the Pioneer Pog 'n' Scroggin Bush Band in Dunedin and since 1986 has played in Wellington's Jimmy Cook Band. He reckons he's learned a thing or two in that time that other players might find useful and is willing to pass them on, provided those attending the workshop tell him some of their secrets as well.

The workshop will look at the differences between reels, jigs, slip jigs, slides, hornpipes etc (especially for those who aren't aware that there ARE differences) and ways they can be accompanied.

The emphasis will be on participation, with a dash of syncopation. Bring stringed things, of the rhythm variety and hitty things (bodhrans, bones etc) to the Social Centre at 1.30 pm Saturday.

### WHISTLE WORKSHOP (Pat Higgins)

Early influences were the Beatles, Simon and Garfunkel and a cousin who, in 1981 loaned Pat a penny whistle and a tutorial book. That summer he learned to play Spancil Hill and almost half of Carolan's Concerto. Pat spent years after that, wandering in the musical wilderness getting goose bumps listening to Matt Molloy, Mary Bergin, Planxty, the Bothy Band ..... In 1990 Pat took up the wood flute and mostly plays that instrument now.

The workshop at 4.00 pm on Saturday afternoon in the Social Room will be a non-introductory look at Irish traditional music; why it sounds the way it does, and how to reproduce that sound. Pat will focus on ornamentation for a short time and then teach a tune using the effects. People will need a D whistle and shouldn't be expected to be taught the basics, such as scales, in this workshop.

### STORYTELLING (Frank Fyfe)

Frank, who admits to being born a Queenslander, first arrived in Wellington some 30 years ago. He settled down to running *The Balladeer* Coffee shop and was a founding member of The New Zealand Folklore Society. He now lives in Greytown, where he fills in his time storytelling to schools, clubs and special interest groups, taking tourists on guided tours and eking out a living sweating away on historic printing presses. Frank is fascinated by the oral tale telling and legend-creating process still alive in rural New Zealand and has published 30 or so stories in his collection; "Tales of the Old Wairarapa".

Frank, who will be the compere for this year's Ballads to Blues, will also entertain big kids with his stories on Saturday afternoon, at 3.00 pm, in the Social Centre. On Sunday afternoon, at 1.00 pm, he'll be doing a special session for the children.

## GROUP THERAPY FOR PIPERS

(Plumbing the depths with Bob Bickerton and Jimmy Young)

Why would anybody want to play the bagpipes? Is there a cure? Is anyone interested anyway? These and many more questions on the psychology of pipers, how to avoid pipers and how to play "safe" music with pipers will be answered by Doctors Young and Bickerton during their early morning romp through what is often considered to be a difficult subject for discussion amongst musicians.

Specialising in Celtic music, Bob Bickerton has performed in most major concert venues and folk festivals around New Zealand in the past 15 years. Experienced in both solo and group performance, Bob has made guest performances with orchestras, choirs and contemporary music performers.

Bob has studied the uilleann pipes in both New Zealand and Ireland and for some time was the organiser of Tionol; the yearly gathering of Irish pipers. Notable performances with the pipes have been with Tim Finn, Moana and the Moa Hunters and Gael Force.

Jimmy Young was first seen in New Zealand with The House Band, at the 10th Whare Flat Festival. He returned to tour with Rua (the Scottish version of the band) and then settled in Christchurch where he's now based. Jimmy specialises in playing the Northumbrian pipes, flute and whistle.

## THE BLUEGRASS CONCERT (The Razorbacks)

The Razorbacks got together one and a half years ago, starting with a repertoire of Stanley Brothers tunes, which has now expanded to incorporate some swing and jazz standards. The Razorbacks regularly perform at the Jazz Junction Wine Bar in Petone, and at many private functions. The Razorbacks are John Young, banjo and vocals; Helen Young, mandolin and vocals; Conrad Lindstrom, guitar; Ian Tompson, mandolin and vocals; and Andrew Bicknell, double bass. The Razorbacks will be performing at 1.30 pm on Saturday afternoon, in the main hall.

### THE WELLINGTON BLUEGRASS SOCIETY

meets on the third Friday of the month in the

PETONE SERVICE CENTRE

BRITANNIA STREET, PETONE



Contact phone: Andrew Bicknell, 477 0069

## **DANCE WORKSHOPS**

All dance workshops will be held in the old gym, adjacent to the main hall. Participants will need to bring soft-soled flat shoes for the classes.

### **Saturday programme:**

10.30 am: Irish Ceili

Teacher: Eileen Do'ricott

12.00 noon: Line dancing

Teachers: Moggie Grayson and Emily Clemmett

2.00pm: Scottish Country Dance

Teacher: Edith Campbell

3.30 pm: Irish Set dancing

Teachers: Lorcan and Anne Dunne

### **Sunday programme:**

11.00 am: Morris

Pride of Hollland Street

1.00 pm: Flamenco

Teacher: Fae Therese

2.30 pm: Children's workshop

Teacher: Glenda Griggs

3.30 pm: Irish Set dancing

**THE  
LOADED  
HOG**



**BAR IN THE BREWERY**

**BOND SREET, WELLINGTON**

**PROUD TO BE ASSOCCAIATED WITH  
THE 1995 NATIONAL FOLK FESTIVAL**

**FULL BAR FACILITIES AND MEALS**

**OPEN ON MONDAY FROM 11.00 AM  
FOR THE LAST SONGS AND DRINKS  
OF THE FESTIVAL**

**CHILDREN WELCOME**

## CHILDREN'S PROGRAMME

The programme of activities is mostly aimed at children aged five and over. Most activities will take place in a classroom, down the corridor from the Social Centre, which will be clearly labelled. The dance class will be in the old gym on Sunday afternoon. Children aged one to five/six will be in the care of Len and Barbara in the creche.

The full programme of activities for children is:

### Saturday programme:

10.30 am     Cartooning with Brent Harpur

1.30 pm     Beginners blues with Daniel Griggs (adults welcome)  
Concert by the curly-haired boy from Karori, Dave Hollis

3.30 pm     Tails, Trails, Trolls and Trials with Liz Merton  
A participatory session of music and drama for kids of all ages

### Sunday programme:

10.30 am     Gorgeous faces will emerge from this do-it-yourself session with  
face painting expert; Paula Mason

1.00 pm     Frank Fyfe will entertain with specially selected stories for a  
young audience

2.30 pm     Dancing in the gym with Glenda Griggs

3.30 pm     Juggling workshop with Julie Daniell

PROMOTING ACOUSTIC MUSIC IN WELLINGTON



SING ROUND SESSIONS 2ND AND 4TH FRIDAYS  
CONCERTS 4TH SUNDAY OF THE MONTH

WELLINGTON COMMUNITY ARTS CENTRE ORIENTAL BAY

CONTACT PHONE: RUTH BIRNIE, 477 4720

## CRECHE

Creche tickets are available from the registration desk - the Creche does not handle money - only tickets and children! Creche facilities, run by Len and Barbara, from the Newtown Community Creche, will be available from:

10.30am to 12.30 and from 1.30 to 4.00pm on Saturday

10.30am to 12.30 and from 1.30 to 5.30pm on Sunday

There will be toys and activities for children aged from one to six years.

Younger babies will be accepted only if there aren't too many older children and the baby seems happy to be left in the creche. Parents are responsible for feeding and changing, but Len and Barbara will be happy to help, provided a snack and changes of nappies are supplied.

Please put a label with both child's and parent's names on the child and tell Len and Barbara where you intend to be while your child is in their care.

**COST: \$2.00 per child per hour**

Please pay at the registration desk before going to the creche as Len and Barbara cannot accept money.

## MADNESS MUSIC COMPANY

NEWTOWN  
SHOPPING MALL  
NEWTOWN,  
WELLINGTON  
Phone/Fax  
389 710Z

OPEN  
SEVEN DAYS  
Just ask for Ciaran



Ciaran will be at the Festival  
from 11am to 3pm  
Saturday and Sunday,  
selling the best available  
Celtic and local Folk Music.

## *Acoustic* Routes presents a **VARIETY NIGHT**

...bringing the spirit of Festivals  
into the Rotunda for a night

Ron Craig    Mary Hubble  
Liz Merton    Kevin Ikin  
Tony Chad    Lynda Hannah  
John Sutherland

**8PM SUNDAY 25 JUNE**

**"UNDER THE ROTUNDA"**

Wellington Community Arts Centre,  
Oriental Parade

Admission \$7.00 WFC Members \$5



THE NEW ZEALAND FOLK FOUNDATION PRESENTS

Cairde, Al Young  
Debbie Gillanders  
Bev Young  
& Friends

Wild Geese  
Gordon McIntyre  
& Kate Delaney  
with  
Jimmy Young

Compère  
Frank Fyfe

**THE 1995  
BALLADS TO BLUES  
CONCERT .**

**8PM SATURDAY 3 JUNE 1995**

**JAMES CABARET, HANIA STREET**

**\$20 (Children \$5)**

## FACILITIES

## LANDMARKS

[illegible]

JAMES CABARET  
(SAT NIGHT)

LOADED HOG  
(MONDAY)

250 m      500 m

1



J. WISE PUBLICATIONS LTD  
SURVEY LAND INFORMATION LICENCE 1956/2



# ONSLOW COLLEGE

TO BURMA LODGE  
and RAROA STATION  
& PARKING.

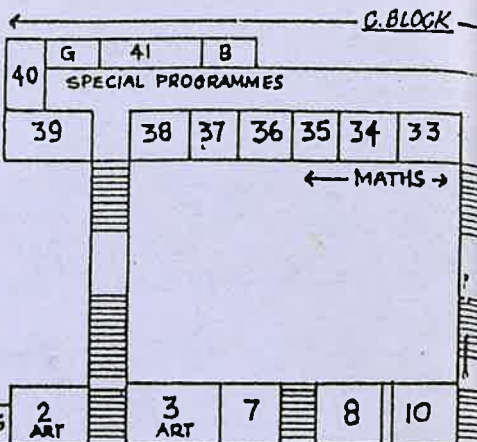

STAFF

PARKING



47

49

43

44

45

TECHNICAL BLOCK

GYM

COURTYARD

HALL

STATIONERY

KITCHEN

FOOD

OFFICE FOYER

OFFICE

N.P.

D.P.

TENNIS COURTS

TO CANTEN

TO FRONT GATES  
(Burma Road)

TO RUGBY & SOCCER  
GROUNDS

NEW  
GYM

PARKING