

1986
PROGRAMME

EVANS BAY PDE

ENTRANCE

PLAN OF ST. PATRICKS

NO
PARKING

CAR
PARK

LECTURE
THEATRE

TOILETS

W003
W004
Senior Common Room

CRECHE

Wet Weather Area

REGISTRATIONS

COURTYARD

TODD
THTR.

SUGGESTED
JAMMING
AREAS *

Wet Weather
Area *

KITCHEN *

MAIN
HALL

Stage

WELCOME

2

..... TO THE 22ND NATIONAL FOLK FESTIVAL.

THANK YOU FOR JOINING US! WE'VE DONE OUR BEST TO MAKE THIS THE BIGGEST, BRIGHTEST, BRILLIANTEST (?) EVER.

THERE IS LOTS TO SEE, HEAR AND EAT (WE GUARANTEE THAT AT LEAST THREE OUT OF THE FIVE SENSES WILL BE TITILLATED - THE OTHER TWO ARE UP TO YOU!)

WE INSIST THAT YOU HAVE A GOOD TIME AND REMEMBER FOR THOSE WHO DON'T SING OR PLAY A MUSICAL INSTRUMENT THAT NO PERFORMER EVER SURVIVED WITHOUT AN AUDIENCE.

REGARDS - VANESSA, BRENT & KEITH (Organiserpersons, who incidentally, will be wearing BLUE badges if you need our help for anything

BILLETS

IF YOU CAN OFFER A BILLET TO A VISITOR OR YOU ARE AN OUT-OF-TOWNER WHO REQUIRES ONE - PLEASE MAKE YOURSELVES KNOWN TO THE REGISTRATION DESK AND WE WILL MAKE EVERY EFFORT TO MATCH YOU UP. IF ALL ELSE FAILS THERE IS EMERGENCY ACCOMMODATION AVAILABLE AT THE FOLK CENTRE.

FOOD

HOT AND COLD SNACKS, TEA AND COFFEES (INCA AND HERBAL TOO!) WILL BE AVAILABLE THROUGHOUT THE FESTIVAL FROM THE KITCHEN.

CONTENTS

page

1	MAP OF ST. PAT'S	13	MORRIS WORKSHOP
2	"YOU ARE HERE"	14	GOSNEY&RUFFELL SONGWRITERS CONCERT/ HOT MUFFIN SERIOUS BAND
3	FRI/SAT TIMETABLE	15	IAN & ANNE LONGLEY KID'S CONCERT
4	SUN/MON TIMETABLE	16	CRECHE & VIDEO
5	JOHN KIRKPATRICK	17	ADS.
6	MARION ARTS & ROBBIE LAVEN	18	BALLADS TO BLUES CONCERT
7	MARG LAYTON & DAVE MURPHY	19	PARTY-TIME
8	MARTHA-LOUISE	20	PUB DAY
9	CHRIS PENMAN	21	Miscellaneous
10	CANTERBURY BUSH ORCHESTRA	22	MAP OF WELLINGTON
11	BRENT BLANN/STEPHEN DELFT	23	FOLKSHOP AD.
12	MICHAEL WILSON/WAYNE ROBINSON		

FRIDAY

6pm onwards: Registrations
 8pm onwards: Welcome Concert come-all-ye Todd Theatre

SATURDAY

MAIN HALL	TODD THEATRE	LECTURE THEATRE	COMMON ROOM	AROUND&ABOUT
10-11.30 John Kirkpatrick mini-concert	Room free for jams, singing or whatever you please ... till 12.30	Room free till 11.30	9.30 - 6.15	<p>Please see map of school for suggested jamming areas.</p> <p>.....</p> <p>Folk Shop, Capital Music and Stephen Delft will have stands open for browsing & buying from time to time: ask at desk for details.</p>
		11.30 - 12.30 Stephen Delft Mixing & Bugging Acoustic Instruments	<p>Creche & childrens' videos</p>	
1-2.30 Dance Workshop with the Canterbury Bush Orchestra	12.30 - 1.30 Chris Penman 'Stand and Deliver' song workshop			
	2-3 mini-concert Marg Layton Dave Murphy			
3-5 North-West Morris with Sue Thomas and White Rose & Clogging Display Albion Pride	3-6 Songwriters' Concert Come-all-ye with Keith Gosney & Trevor Ruffell	3.30 - 4.30 Wayne Robinson Dynamics of group playing - Bluegrass		
		5-6 Big Muffin Serious Band ukulele workshop		
6-8 Time to refuel for the ...				
8-12 ... Saturday Night Knees-Up with the Canterbury Bush Orchestra				Main Hall

SUNDAY

MAIN HALL	TODD THEATRE	LECTURE THEATRE	COMMON ROOM	AROUND&ABOUT
	10-11 "My Songs" Songwriting workshop Phil Garland	10-11 Martha Louise Dulcimer workshop	9.30 - 1.30 Creche & Childrens' videos	<p>Please see map of school for suggested jamming areas</p> <p>.....</p> <p>Folk Shop, Capital Music, and Stephen Delft will have stands open for buying & browsing from time to time: ask at desk for details</p>
11-12.30 Border Morris with John Kirkpatrick	11.30-12.30 Robbie Laven Marion Arts Intercultural Eclecticism	room free till 1		
	1-2 Brent Blann Guitar workshop	1-2 Stephen Delft Guitar & Fretted Instrument Care	1.30-3 Children's Workshop "This Is Me" with Ann & Ian Longley	
	2-4 Come-all-ye	room free	3-4.15 Creche	
3- Hall Cleaning Party				
4-8	Cleaning up & leaving St Fats ... & last chance to rest & recharge batteries before			
8-11	Ballads to Blues			State Opera House
Midnight to Dawn	Party			Railway Social Club Hall Platform 9
MONDAY		11-?	Pub Day Bond St Inn	

John's musical expertise is probably more in demand than any other musician's from the British folk scene. As a master of the whole range of "squeeze boxes" (as they are impolitely known) - more exactly the accordeon, melodeon and concertina - he's appeared on records by artistes as diverse as Richard and Linda Thompson, Ralph McTell, Gerry Rafferty, Julie Covington, Allan Taylor, Martin Carthy, Tony Rose, Viv Stanhall, Shusha and many others. He's recorded as a member of both Steeleye Span and the Albion Band, with Sue Harris, as part of country dance band Umps & Dumps, yet somehow also manages to find time for solo dates and recording. Small wonder that a folk magazine is currently devoting the best part of three issues to describing his musical career.

John was already an accomplished musician long before he turned professional in 1970 or made his first solo album in 1972. He had played with the Hammersmith Morris and various country dance bands over the previous decade, having started on melodeon and accordeon at the tender age of 12. Early in the '70's he was spotted by ex-Fairport Convention bassist Ashley Hutchings and was involved by him in Shirley Collins' "No Roses" album, the early Albion Country Band, and the famous electric album of morris tunes, "Morris On".

Around this time, his musical partnership with Sue Harris got well under way, to produce (so far) four Topic albums of an absolutely distinctive instrumental and vocal combination, plus many a fine gig.

John's association with the folk-rock movement was to continue throughout the '70s. He became a regular session man for Richard and Linda Thompson's records and tours, was involved in more of Ashley Hutchings record and stage projects (including the National Theatre productions of Lark Rise and Candleford), and was drafted in by Martin Carthy to join the classic folk-rock band Steeleye Span for two albums and touring.

His interest in morris dance resulted in one of the '70s seminal folk album projects, the "Plain Capers" album, and the formation of one of the most dynamic and entertaining morris sides seen in recent years, the Shropshire Bedlams. Similarly, his continuing involvement with country dance music sees him in Umps & Dumps, whose first Topic album was released in 1981.

On top of all this, John is also a songwriter of some repute, perhaps best showcased on another solo album, "Going Spare" (Free Reed). This contained the original version of his almost-hit single "Jogging Along With Me Reindeer".

Currently, apart from his solo work, that with Sue Harris and Umps & Dumps, his "live" dates with Martin Carthy and Howard Evans (another ex-Albion Band member) are attracting lots of attention.

Watch out for John's Mini Concert on Saturday 10 a.m. and Morris Workshop Sunday 11.00 a.m. both in MAIN HALL.



JOHN KIRKPATRICK

Marian has been writing songs since she was 3 -started playing guitar soon after! She was a hit at the "1970 Banjo Pickers Convention and appears on the record made from the festival. She currently writes most of their material.

Robbie was a major influence on the Auckland folk scene from mid to late 60's. Has backed Marilyn Bennett and done duos with Chris Thompson. Started the hugely successful "Mad Dog Jug Jook & Washboard Band" in the late 60's. A true multi-instrumentalist and brilliant guitarist.

Marian and Robbie joined together in the "1953 Memorial Society Rock n Roll band" (camped up R 'n Roll) and toured N.Z. 1971 to 1973. They made a record "Toujours Yours" and left for Australia with the band where they recorded a further three records.

In 1975 Robbie and Marian formed "Red Hot Peppers" which performed folk, rock and jazz. (A band remembered very fondly judging by comments made since it was known Robbie and Marian were to be guests - Ed)

In 1980 they toured Europe very successfully (based in Holland where they both have family roots) and recorded a further three L.P.'s (all Dutch pressed).

Returned to N.Z. in 1985 to pursue separate musical developments and "to be nice to each other". Together especially and only for this festival!

Apart from their welcome appearance in the "Ballads to Blues" concert join them for their mini-concert in the TODD THEATRE, on Sunday at 11.30 a.m.

MARIAN ARTS & ROBBIE LAVËN



Marg has appeared at a wide range of venues - folk and jazz clubs, major festivals, (most recent being the Fringe Festival of the International Festival of Arts), house concerts, art galleries, prisons, university campuses and the pub, theatre and restaurant scene. Supporting acts for International touring artists have included Country Joe McDonald, Don McLean, Bob Fox and Stu Luckley and Tom Paxton.

She has compiled, presented and sung in numerous radio programmes including a live concert for "Jazz Tonight". Her most recent concert for T.V. was "Jazz Seen" in November 1985.

Major influences on Marg's blues singing have been Alberta Hunter (whom she met in New York in Nov' 80), Robert Johnson, Memphis Minnie, Odetta, Ma Rainey, Bessie Smith, Koko Taylor and Sippie Wallace.

Marg has performed with many of N.Z.'s top folk and jazz musicians including Brent Blann, Kevin Clark, Andrew Delahunty, Paul Metsers, Chris Prowse, Colin Speir and Max Winnie. Most recently she has teamed up with

..... Dave Murphy began playing guitar in 1971 at age 15, but it wasn't until 1977 that he devoted himself to the blues. Concentrating initially on fingerstyle blues but later incorporating electric techniques as well.

Dave has become recognised as a leading exponent of this style in N.Z. and had performed in Australia and Europe as well. He has also toured with the "Backdoor Blues Band" and more recently with Ted Clarke and Gary McCormick on the "Out of the Blues Tour". Currently holds down residency at the Oaks Tavern with his band "The Jute Jivers".

No stranger to the folk scene Dave has performed at the folk club and was featured artist at the 1984 National Folk Festival.

Marg and Dave collaborated late last year to play hokum blues and hard hitting Memphis Minnie material. They performed at Downstage, the Wellington Folk Centre and Summer City to enthusiastic audiences.

Apart from their appearance in the Ballads to Blues concert Marg and Dave will be performing in their own mini-concert in the TODD THEATRE, Saturday, 2.00 p.m.



MARG LAYTON & DAVE MURPHY



Since moving to N.Z. from the USA in the early '70's, Martha-Louise's singing and assured guitar playing have earned her a place in many folk gatherings as well as on TVNZ's "That's Country". Her repertoire includes original songs as well as gospel, country and more.

Has recently released her first album "MIXED FEELINGS" on Ode Records, ably assisted by Cath Woodman, Bev Young, Colin Speirs and Nick Brown. This album was chosen as a finalist in the N.Z. Music Awards last year.

Her most recent appearances have been at the Devonport Folk Club and the Auckland Folk Festival. Now it's our turn - "Whoopee!"

Martha-Louise will be running a DULCIMER WORKSHOP at 10.00 a.m. on Sunday morning in the LECTURE THEATRE as well as appearing in the Final Concert.

LOOK OUT FOR "MIXED FEELINGS" WHICH WILL BE ON SALE AT FESTIVAL SITE!

MARTHA-LOUISE



When asked to provide her musical background Chris advised - "Chris sings" which sums it up quite nicely.

However there is more

She was brought up in a very musical family and naturally drifted into singing at an early age. Not everyone knows that she won the 1974 Buzz o'Bumble talent quest which of course was a turning point in her career.

Chris sings everything she can lay her voice on but is most cherished and admired for her expertise at British Trad. Has recently appeared on a T.V. special and features (brilliantly!) on Martins Curtis' latest album "Back From The Hills".

Don't miss her workshop entitled "STAND AND DELIVER" at 12.30 p.m. on Saturday in the TODD THEATRE.

CHRIS PENMAN



Members of the Canterbury Bush Orchestra have been making music together for the last 5 years and bring to the stage a wealth of performing experience both individually and collectively here in N.Z. as well as overseas.

Dedicated to recreating this country's early musical heritage by way of Barn and Wool Shed dances, the group (JOHN ALLAN, SUE ALLAN, PETER MORGAN, GERRI GARLAND & PHIL GARLAND) appear regularly throughout the South Island performing in Concert, at Folk Festivals, Radio, T.V., Ceilidhs, Socials and Weddings etc... delighting audiences young and old alike with their vigorous toe-tapping and authentic brand of colonial music and song.

The name Canterbury Bush Orchestra is no misnomer, for between them they play 16 instruments in all! These include concertina, fiddle, lagerphone, bodhran, bush bass, guitar, whistle and and and and.....

Apart from their appearance at the Final Concert you can see the groups DANCE WORKSHOP 1.00 p.m. on Sat in the MAIN HALL; PHIL GARLANDS WORKSHOP at 10.00 a.m. Sunday and last but definitely not least they will be providing music for our SATURDAY NIGHT KNEES UP in the MAIN HALL.

THE CANTERBURY BUSH ORCHESTRA

Brent started playing guitar about 1968. He must have got quite good at it because he's been a guest at many festivals and main guest at many concerts around N.Z. In fact he assures me he's quite famous outside Wellington!

His specialities are ragtime, folk blues, country blues, Trad British and has a secret bent towards C & W. He is every ones favourite accompanist covering diverse styles from Marg Layton's blues to Chris Penman's trad.

BRENT BLANN



This weekend Brent is having a turn behind the scenes as a festival organiser/photographer (Spot his great photo on the poster!) However he will come out to treat you to a GUITAR WORKSHOP in the TODD THEATRE, 1.00 p.m., Sunday

He plans to cover modern N.Z., ragtime, arrangement of folk blues plus other styles.

P.S. He nearly did support for P, P & M but they couldn't stand the competition!

STEPHEN DELFT

Started playing fretted instruments at age 10. Started repairing own and friends' instruments at age 15. Learned from John Bailey and European instrument makers and full-time study in musical instrument technology.

Became first graduate member of Institute of Musical Instrument Technology with a thesis on Mediaeval Lute.

Own business in London for 20 years making and repairing musical instruments and sound equipment. During this time also, five years lecturer in Musical Inst. tech. then five years writer and technical consultant for International Musician magazine, then technical editor of Acoustic Music and Folk International.

Also during this time performed as solo singer/songwriter and lead the Patriarch of Glastonbury's Band, performing Early Music and looning around with a dancing bear.

Acquired a reputation as Europe's top musical instrument technologist and surprised everyone by coming to settle in N.Z. three and half years ago.

Conducting two workshops both in the LECTURE THEATRE.
Saturday 11.30 a.m. - "MIKING AND BUGGING ACOUSTIC INSTRUMENTS"

Sunday 1.00 p.m. - "GUITAR AND OTHER FRETTED INSTRUMENTS CARE"



MICHAEL WILSON

12.

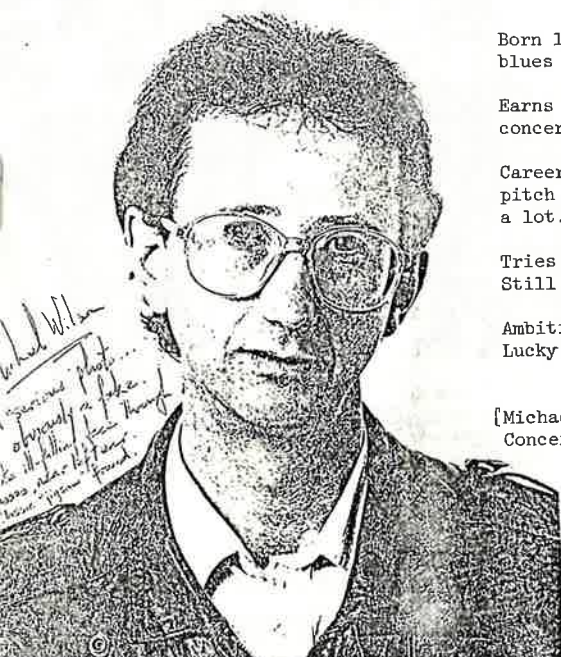

Born 1952 a 'rhesus factor' baby into blues ever since.

Earns a living fronting charity and benefit concerts ... can't work out why no income yet.

Career in music yet to take off - had perfect pitch but nobody wants to play on it. Frets a lot. Highly strung. Crotchety.

Tries to contact Jimi Hendrix in seances. Still awaiting feedback.

Ambition - to want something.
Lucky number - purple.

[Michael will be compering our BALLADS TO BLUES Concert on Sunday night.]

WAYNE ROBINSON



Wayne has played the 5-string banjo for the last 17 years. He was a founding member of the Christchurch based bluegrass band "Slim Pickin's" and is currently playing in a Wellington band "Panama Red".

He does session work for local and national radio jingles as well as various record companies and artists. He is one of the only bluegrass banjo teachers in the Wellington region.

The name of Wayne's workshop is "THE DYNAMICS OF GROUP PERFORMANCE". Its scope will be to cover many aspects of acoustic music performances with and without a sound system. To identify the problem areas of both individual performers within a group context and group performances in new bands. He will use a live band and taped music to demonstrate with. LECTURE THEATRE, 3.30 p.m., Saturday.

13.

MORRIS

The MORRIS DANCE WORKSHOPS are designed to introduce you to Morris dancing so don't worry if you've never danced before. All you need is a sense of fun, an open mind and gym shoes or something similar.

For the totally uninitiated, Morris is a form of traditional English dance formerly associated with seasonal festivals.

Many of the figures and movements can be interpreted as relics of battle, sacrifice and fertility rituals, but to us it is mainly a way of expressing vigour and joy. and is very satisfying to do. The vital music adds to this satisfaction.

Come along and see for yourselves.



SATURDAY, 3.00 a.m. MAIN HALL Sue Thomas, forwoman of "WHITE ROSE" will be teaching dances of the North West tradition.

Errol and Hilda, two members of the "ALBION PRIDE" will be demonstrating CLOG DANCING in the same session (about 4.30).



SUNDAY, 11.00 a.m. MAIN HALL John Kirkpatrick - who you remember danced on the "Steeleye Span" record LIVE AT LAST - musician and dancer extraordinaire will be teaching and playing for dancers of the "WELSH BORDER".

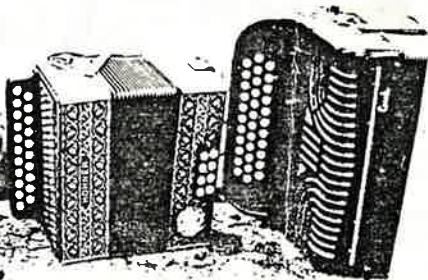



SONGWRITER'S CONCERT

CONDUCTED BY
KEITH GOSNEY &
TREVOR RUFFELL

TO BE HELD ON SATURDAY IN THE TODD
THEATRE FROM 3.30 p.m.

HINT Trevor and Keith are on the
lookout for homegrown PEACE songs
to put on a compilation album.



WATCH OUT FOR THEIR FOLKSHOP WHICH IS SET UP BY
THE REGISTRATION TABLE. (See ad elsewhere)



With a name like BIG MUFFIN SERIOUS
BAND you know they must be fun.
Believe me they are!

They have been wowing audiences at
recent festivals (Dunedin and
Hamilton where they come from) not
to mention lunchtime punters in
Manners Mall (which is where the
writer saw them and loved them!).

They play an unusual variety of
instruments e.g. T-Chest Bass,
kazoo, uke - and they do it with
style. Note the kazoo attached to
mike stand!

Their workshop is on Saturday, 5.00 p.m. in the LECTURE THEATRE and will focus
on the UKULELE chord structures, Rock n Roll use and alternative tunings.

Who knows what may happen - but don't miss them!

(There is a fourth member of the group who does not feature in the photo, you
will have to spot him at the workshop.)

"THIS IS ME!"

THIS IS A PERSONAL INVITATION TO ALL NON-ADULTS TO COME AND SHARE WITH OTHERS WHAT YOU CAN DO IN A CONCERT.

YOU DON'T HAVE TO BE GOOD, REMEMBER WE WANT TO HAVE FUN.

INSTEAD OF THE USUAL WORKSHOPS - WHICH IS DOING WHAT WE WANT - ANN & IAN LONGLEY WILL BE AROUND THE FESTIVAL ON SATURDAY AND SUNDAY AND ARE JUST WAITING FOR YOU TO SAY "HEY, CAN YOU HELP ME TO BE READY FOR THE "THIS IS ME" CONCERT.

THEY CAN HELP YOU WITH MUSIC, SONGS, POEMS OR ANYTHING YOU WANT TO DO, EITHER ON YOU OWN OR WITH FRIENDS.

IF YOU DON'T KNOW ANN OR IAN - ASK OTHER KIDS, BE DETECTIVES.

THIS IS YOUR CHANCE TO SAY "THIS IS ME!" ON SUNDAY AT 1.30 p.m. IN COMMON ROOM

**IAN
&
ANNE
LONGLEY**

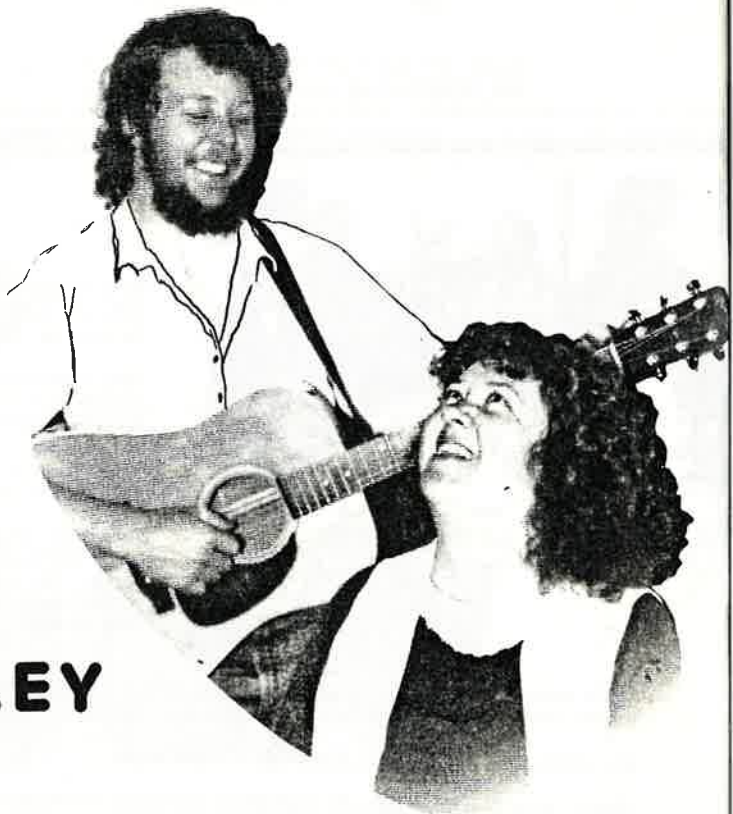

PLACE: SENIOR COMMON ROOM

TIMES: SAT - 9.30 a.m. to 6.15 p.m.

SUN - 9.30 a.m. to 1.30 p.m.
3.00 p.m. to 4.15 p.m.

COST: SAT - \$2.00 a.m. / \$2.00 p.m. / \$4.00 DAY /

SUN - \$2.00 a.m. / \$1.00 p.m. / \$3.00 DAY /

EACH EXTRA CHILD WILL COST \$1.00 PER SESSION. i.e. 2 kids all day = \$6
3 kids a.m. = \$4

NOTE: PLEASE PURCHASE CRÊCHE TICKETS FROM THE REGISTRATION DESK IN THE MAIN HALL.

YOU MUST TAKE RESPONSIBILITY FOR FEEDING AND CHANGING YOUR CHILDREN.

CHILDREN WILL ONLY BE ACCEPTED IF THEY OBVIOUSLY FEEL O.K. ABOUT BEING THERE.

--oo0oo--

VIDEOS which will be shown in the CRÊCHE area that are suitable for children (up to age 13) will be played through out most of the two days. Those children not requiring crêche care but wishing to watch videos will gain entry by buying crêche tickets as priced above from Registration.

--oo0oo--

[The National Folk Festival Committee is happy to provide these services and are to a large degree subsidising them. It would be appreciated by us and by the women of the Hataitai Playcentre who are personning the creche if you would pay heed to our simple, but essential NOTES above.

- THANKS]

CRÊCHE & VIDEO



Gisborne Music Centre

ARTHUR TOMS
Managing Director

Sole N.Z. Agents for
Fylde Guitars • Albion Guitar Strings

24 PEEL STREET

PHONE 76-178

1915 Gibson A-1 mandolin and original case, well-used but not abused, \$1575 o.n.o.

Fylde "Ariel" and Calton fibreglass case, available very soon ex stock, \$2575; all other Fylde models available to special order, approximately 4-5 months' delay.

Continually changing stock of folk records, including Judy Small imports.

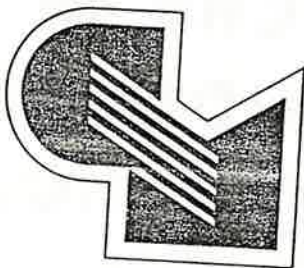
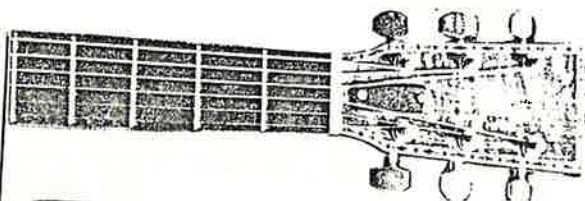

CAPITAL MUSIC LIMITED

Specialist Musical Instrument Consultants

106 COURTENAY PLACE

P.O. BOX 6676, WELLINGTON

TELEPHONE 859-340

ballads to blues



the concert

john kirkpatrick
chris penman
martha louise
robbie laven
marion arts
dave murphy
marg layton
phil garland
& the canterbury
bush orchestra

JUNE 1ST
OPERA HOUSE
8pm \$10

PARTY TIME AGAIN

WELL IT'S ON AGAIN FOR
THE YOUNG AND OLD AT
THE NO.9 PLATFORM
HALL.

THE MIDNIGHT TO DAWN
PARTY THAT HAS BECOME A
TRADITION AT THE NATIONAL
FESTIVAL AFTER THE BALLADS TO
BLUES PARTY.

BRING ALONG YOUR FAVOURITE
JUICE AND YOUR STRONGEST
SINGING VOICE TO KEEP UP
WITH THE SINGING AND THAT
SHOULD BE IN FINE FORM.

THERE IS ROOM FOR ALL TO TAKE
PART IN WHATEVER THEIR MUSICAL
PREFERENCES ARE SO HAVE YOUR
INSTRUMENTS READY AND GET SET
FOR ANOTHER GREAT ALL NIGHTER.



YOU
ARE
ALL
INVITED

No 9
platform
midnight
to
Dawn

IF YOU NEED A RIDE TO
THE PARTY, THERE WILL
BE A MINI VAN AND SOME
CARS TO PICK YOU UP SO
JUST WAIT OUTSIDE THE
OPERA HOUSE AND GRAB
A RIDE *****

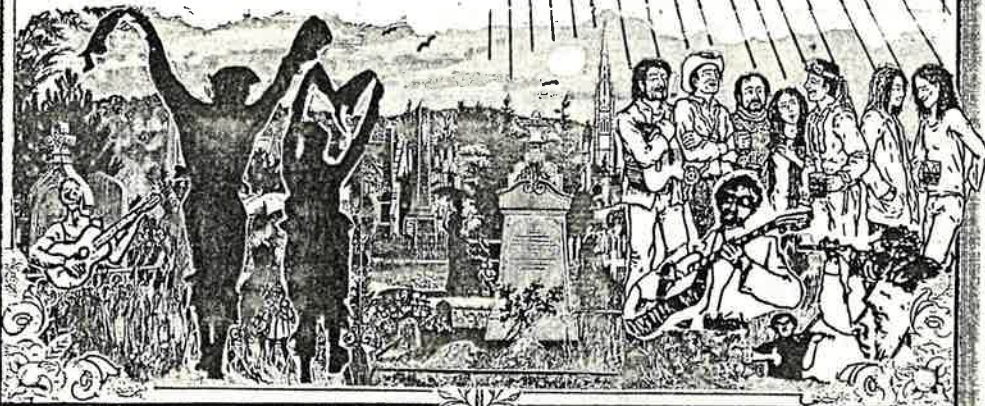

20
MONDAY

Bond St
Inn



PUB DAY

11-00 am

ALL ROADS LEAD TO THE BOND ST. INN ON MONDAY MORNING WHERE ALL WHO ARE LEFT OR CAPABLE, GATHER FOR A VERY FINE MEAL AND ALE IN PLUSH RED VELVET SURROUNDINGS TO EAT, SING, DRINK YOUR FILL and SAY FAREWELL TO NEW AND OLD FRIENDS UNTIL YOU SEE THEM AT THE NEXT FESTIVAL.

THERE WILL BE A MENU OF MEAT, FISH, AND VEGETARIAN FOOD AT A COST OF AROUND THE \$6.00 MARK. THE INN WILL OPEN FOR US AT 11.00am AND AFTER 9 00pm WILL TAKE BACK THEIR PUB.

SEE YOU THERE.

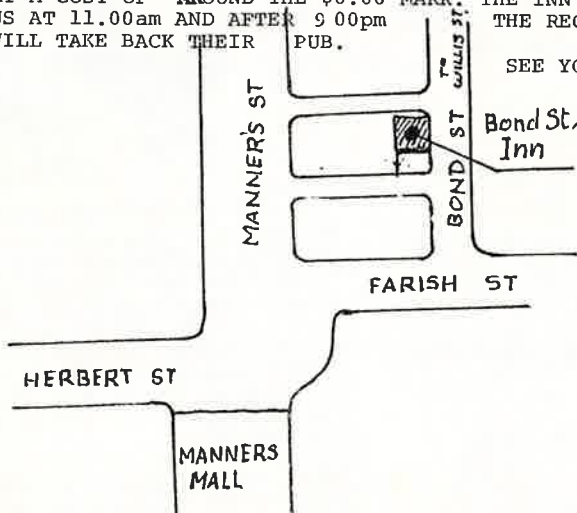

 THE NATIONAL FOLK FESTIVAL COMMITTEE WISHES TO ACKNOWLEDGE AND THANK THE REGIONAL
 ARTS COUNCIL FOR ASSISTANCE WITH A \$1000 GRANT.

HELPFUL HINTS:

- * Remember to wear your red festival badge to the "Ballads to Blues" Concert as it ensures you FREE entry!
- * The kitchen which is being run by Margaret Fells provides snacks only. For those evenings where something more substantial is required any Wellingtonian will be happy to provide you with details of their favourite eating haunts.



10 Holland Street. Telephone 850 617. PO Box 27-191, Wellington

Finding out what's on

Our monthly magazine, the *Balladeer*, has details of most folk activities in the Wellington area. You can subscribe, or buy a copy, at the Folk Centre. Copies are also displayed in the Public Library music room.

You can also ring the club (850 617) on a Friday night, to check what's on.

But the best way is to call in and see!

Where we are

Tucked away just off the beaten track on the first floor of 10, Holland St...

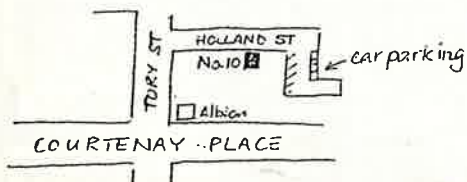

Come up and see us sometime!



ARE YOU A HELPFUL PERSON??

WE KNOW THAT SOMEWHERE OUT THERE THERE IS A WONDERFUL BAND OF FOLKIES WHO COME FORWARD EVERY YEAR TO MAKE THEMSELVES AVAILABLE FOR CLEAN-UP DUTIES ON MONDAY MORNING TO HELP THE TEAM FINISH EARLY ENOUGH TO GET TO THE BOND ST. INN IN TIME TO HAVE LUNCH AND NOT MISS OUT ON THE SINGING ETC.

THERE WILL BE A LIST AT THE DOOR DURING THE WEEKEND FOR YOU TO WRITE YOUR NAME DOWN OR JUST! CONTACT ONE OF THE COMMITTEE AND TELL THEM.....



MAP OF FESTIVAL SITES



WELLINGTON

BOND ST. PUB

OPERA HOUSE

ORIENTAL BAY

MT VICTORIA

HATAITAI

THIS IS THE 'PRETTY' WAY!

HOLLAND ST
FOLK CLUB

BASIN
REACTIVE

MT. VICTORIA
TUNNEL

ST. PATRICKS
COLLEGE

NEW TOWN



imported folk records from the FOLKSHOP



FOLKSHOP IS PROUD TO PRESENT A
SELECTION OF THE FINEST IMPORTED
FOLK MUSIC RECORDS AVAILABLE IN NEW
ZEALAND FOR SALE AT THE 1966 NATIONAL
FOLK FESTIVAL OF NEW ZEALAND.
LABELS INCLUDE, MULLIGAN, TOPIC, HIGHWAY
HUBBER, CELTIC, LARRIKIN, FLYING FISH
ROUNDER, BLACKTHORN AND OTHERS.

MAKE YOUR SELECTION NOW AND USE
OUR NEW ZEALAND WIDE MAIL ORDER SERVICE.
SEE OUR SELECTION EVERY DAY OF THE
FESTIVAL